

A4 Monochrome Multifunction Printer

Apeos 4620 SZ

A4 Monochrome Printer

ApeosPrint 4620 SDW

Driving productivity to the next level



 Apeos™

 ApeosPrint™



The Apeos 4620 SZ and 4620 SDW machines are robust and compact, a practical solution for busy offices.



Apeos 4620 SZ

Apeos 4620 SZ

Product	Print Speed	Printing Resolution	Control Panel	Ethernet	Wi-Fi
Apeos 4620 SZ	Monochrome 46 ppm* ¹	1,200 × 1,200 dpi* ²	Colour Touchscreen 3.5 inches	Gigabit (1000BASE-T)	Standard

ApeosPrint 4620 SDW

Product	Print Speed	Printing Resolution	Control Panel	Ethernet	Wi-Fi
ApeosPrint 4620 SDW	Monochrome 46 ppm*	1,200 × 1,200 dpi	1-Line LCD	Gigabit (1000BASE-T)	Standard



ApeosPrint 4620 SDW

Powerful

- Great functions & performance improve workflow & productivity within an office.
- High speed (46 pages per minute) printing helps get the job done fast.
- Additional paper tray option helps improve productivity for users with high print volume by reducing routine of replenishing paper.
- Large capacity toner units reduces the need for toner replacements.
- Automatic Document Feeder enables speedy single-pass two-sided scanning.*
- Users can select different paper quality and thickness according to their needs.
- Legal-size documents can be copied and scanned.*
- Print Resolution: 1,200 x 1,200 dpi.
- Gigabit Ethernet®1000BASE-T.
- Fujifilm Print Utility, AirPrint, and Mopria® Print Service are supported.



Print Utility



Convenient

- Compact, sensible and stylish design.
- You select an access method that works for you. Simultaneous connection with Ethernet and Wi-Fi Direct enables easy connection with the machine.
- Directly printing from or scanning to USB flash drive.*
- Copy an ID card on one side of a sheet*

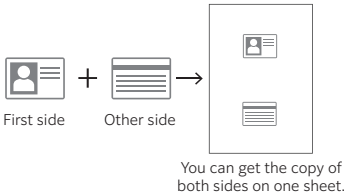

Reliable

- Responds to your high-volume printing needs with high durability (Machine life up to 300,000 pages).
- Secure Print function enables you, and only you to print and access your own output on-demand.
- The Secure Function Lock feature means that you can control who accesses & uses the various functions of the machine to copy, scan or fax. Page limits can be set to help you manage costs.*

*Applicable for Apeos 4620 SZ only.

Protect your confidential information & reduce security risk

- Limit user access through the utilisation of LDAP or Windows Active Directory.
- Impose restrictions on usage of device functions with Secure Function Lock and Setting Lock.
- Ensure device integrity with runtime intrusion detection, Secure Boot, firmware with digital signatures, and end-to-end encrypted connections.

Two-way (front & back) printing output

- Simply select the output point (front or back output tray) that matches the type of paper to be used.
- The machine adopts a straight paper path, which produces face-up print output. Minimal curling when using thick paper.

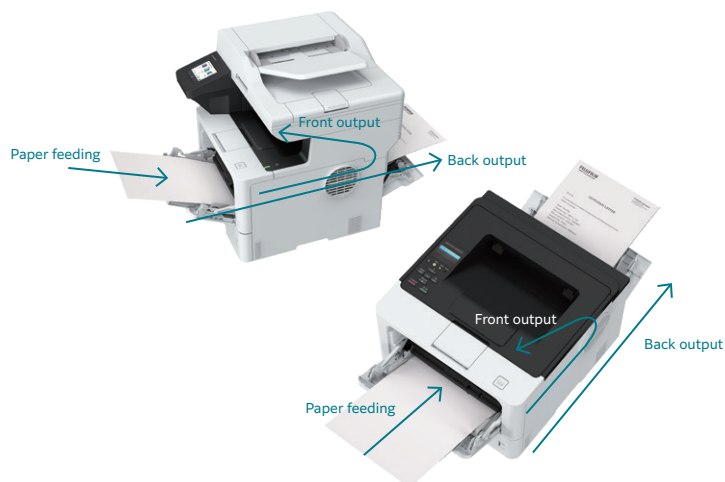

Packed with smart features

- Easy Front Access: Access print output and replace consumables (such as toner and paper) quickly, simply and cleanly from the front of the machine.

- 1. Automatic Document Feeder:** Quickly scan, copy and fax one or two-sided, and multiple-page documents. Also Flatbed is convenient to scan thick documents such as books.*
- 2. USB Port:** Use your own USB flash drive to save scans or print directly from the USB port.*
- 3. Bypass Tray (100 sheets):** Capable of handling different types & sizes of paper, envelopes, labels, and post cards.
- 4. Standard Tray (250 sheets):** This tray is for standard users. Various types & sizes of paper can be used.
- 5. 520 Sheet Feeder*1:** Even if users want to print high-volume documents, the machine can respond to the needs with a maximum paper feeding capacity 1,390 sheets*2.

Note: Paper feeding capacity is based on 80 gsm paper.

*1: Optional. 250 Sheet Feeder and 520 Sheet Feeder are available. Up to two optional feeders can be added.

*2: When two 520 Sheet Feeders are added.



250 Sheet Feeder (Optional)

Item	Description
Paper Size	Max: A4, Letter, Legal Min: A5
Paper Weight	60 to 120 gsm
Feeding Capacity / Number of Tray*	250 sheets x 2 Tray
Dimensions	W 363 x D 384 x H 122 mm
Weight	2.8 kg

* 80 gsm paper.

520 Sheet Feeder (Optional)

Item	Description
Paper Size	Max: A4, Letter, Legal Min: A5
Paper Weight	60 to 120 gsm
Feeding Capacity / Number of Tray*	520 sheets x 2 Tray
Dimensions	W 363 x D 384 x H 152 mm
Weight	3.9 kg

* 80 gsm paper.

Easy to use interface*

- The machine features 3.5 inch* intuitive colour touch panel that allows you to swipe through the menu with ease.
- To start the operation, simply touch the colour touch panel. When you finish the operation, the display on the panel automatically turns off. Easy to use and energy saving.

Consumables

Product Name	Product Code	Product Life
Toner Cartridge (Starter)	-	Up to 3,000 pages
Toner Cartridge Ultra High Capacity	CT204231	Up to 18,000 pages*1
Drum Cartridge	CT351436	Up to 73,000 pages*2

*1: Published value based on ISO/IEC 19752 standards. The actual number of printable pages may vary significantly from the published value, depending on printing content, paper size, paper type, usage conditions, and other such usage environment conditions.

*2: Approximately 45,000 pages based on 1 page per job and 73,000 pages based on 3 pages per job. The number of pages may be affected due to a variety of factors including but not limited to media type and media size.

Notes:

1. To comply with paper weight specifications, it is recommended to use our recommended paper. Document may not be printed correctly depending on usage conditions.
2. Functional spare parts will be available for at least 7 years after the product is no longer manufactured.

*Applicable for Apeos 4620 SZ only.

Apeos 4620 SZ

Functions & Specifications

Basic Specifications / Copy Function

Item	Description
Type	Desktop
Memory capacity	1 GB (Max: 1 GB)
Storage Device Capacity	-
Scan Resolution	600 x 600 dpi
Printing Resolution	1,200 x 600 dpi
Warm-up Time *1	27 seconds or less (23 degrees Celsius room temperature)
Recovery Time (Recovery Time from Sleep mode)	7 seconds or less (23 degrees Celsius room temperature)
Original Size	Maximum A4 by Platen, Legal by Feeder
Paper Size	Max A4, Letter, Legal, Folio (216 x 330 mm)
	Min A6[69.8 x127 mm when using Bypass Tray]
Image loss width	Lead edge 4.0 mm, Trail edge 4.0 mm, Right/Left edge 3.0 mm*2
Paper Weight*3	Paper Tray 60 to 163 gsm
	Bypass Tray 60 to 230 gsm
First Copy Output Time	8.7 seconds or less (A4, Ready Mode)
Continuous Copy Speed*4	B/W: 46 ppm (A4)
Paper Tray Capacity*5	Standard Standard Tray: 250 sheets + Bypass Tray: 100 sheets
	Optional 250 Sheet Feeder: 250 sheets, 520 Sheet Feeder: 520 sheets
	Max 1,390 sheets (Standard Tray+ Bypass Tray + 520 Sheet Feeder x 2)
Output Tray Capacity*5	150 sheets (face down), 10 sheets (face up*6)
Power Supply	AC220-240 V +/- 10 %, 10A, 50/60 Hz common
Maximum Power Consumption	1,280W
	Sleep Mode: 0.6 W Ready Mode: 31 W
Dimensions	W 417 x D 461 x H 448 mm
Weight*7	16.2 Kg

*1: It may change depending on usage conditions.

*2: The value represents median.

*3: It is recommended to use our recommended paper. Correct print output may not be possible depending on the requirement.

*4: The speed may be reduced due to the temperature conditions.

*5: 80gsm paper.

*6: Face up with rear cover open.

*7: Including Toner Cartridge, Drum Unit.

Print Function

Item	Description
Type	Built-in type
Continuous Print Speed*1	Same as the Basic Specifications / Copy Function
Printing Resolution	300 x 300 dpi, 600 x 600 dpi, 2,400 x 600 dpi, 1,200 x 1,200 dpi
Page Description Language	PCL6, PostScript language compatibility
Supported Operating System*2	Windows 11 (64 bit), Windows 10 (32 bit / 64 bit), Windows Server 2022 (64 bit), Windows Server 2019 (64 bit), Windows Server 2016 (64 bit) macOS 14 / 13 / 12
Interface	Standard Ethernet 1000BASE-T / 100BASE-TX / 10BASE-T
	USB Hi-Speed 2.0 Wireless LAN (IEEE802.11 b/g/n)

*1: The speed may be reduced due to the temperature conditions.

*2: Please refer to our official website for the latest supported OS.

Scan Function

Item	Description
Type	Colour Scanner
Scan Resolution	1,200 x 1,200 dpi (from Flatbed), 600 x 600 dpi (from Automatic Document Feeder)
Scan Speed	Same as the Scan Speed for the Automatic Document Feeder
Interface	Ethernet 1000BASE-T / 100BASE-TX / 10BASE-T, USB2.0, Wireless LAN

Fax Function

Item	Description
Original Size	Max: A4, Letter, Legal*1, Folio (216 x 330 mm)
Recording Paper Size	Max: A4, Letter, Legal*1, Folio (216 x 330 mm); Min: A5
Transmission Time	2 seconds and more but fewer than 3 seconds*2
Transmission Mode	ITU-T Super G3
Applicable Lines	Telephone subscriber line, PBX, Fax communication (PSTN), Maximum 1 port*3 (Super G3-1 port)

*1: Not available on Flatbed for Apeos 4620 SZ.

*2 When A4 size document with approximately 700 characters is transmitted in standard image-quality (8 x 3.85 lines/mm) and in high-speed mode (33.6 kbps, JBIG). Only indicates the time for transmitting the image information and does not include the communication control time. The total communication time will vary depending on the contents of the document, the type of machine receiving the fax, and line condition.

*3: No. of FAX lines is up to port. Port refers to number of channels for FAX.

Automatic Document Feeder

Item	Apeos 4620 SZ
Type	1 pass, 2 sided scanning Automatic Document Feeder
Original Size / Paper Weight	Max*1: Legal ; Min*1: A6 60 to 105 gsm
Capacity*2	50 sheets
Scan Speed*3	B/W: 28 ppm, Colour: 20 ppm 1 pass, 2 sided scanning, B/W: 56 ppm, Colour: 40 ppm [Standard Document (A4), 300 dpi, to PC]

*1: Custom size (105 x 147.3 mm to 215.9 x 355.6 mm)

*2: 80 gsm paper.

*3: The scanning speed varies depending on the documents.

ApeosPrint 4620 SDW

Functions & Specifications

Basic Functions & Specifications

Item	Description
Printing Method	Laser electrophotography
Warm-up Time	25 seconds or less (23 degrees Celsius room temperature).
	6 seconds or less from Sleep Mode(23 degrees Celsius room temperature).
Continuous Print Speed*1	Simplex 46 ppm
	Duplex 24 ppm
First Print Output Time*2	6.7 seconds or less(A4)
Printing Resolution	300 x 300 dpi, 600 x 600 dpi, 2,400 x600 dpi, 1,200 x1,200 dpi
Paper Size	Standard Tray A4, Letter, JIS B5, A5, A5 LEF, A6, Executive, Legal, Folio (216 x 330 mm)
	Bypass Tray A4, Letter, JIS B5, A5, A5 LEF, A6, Executive, Legal, Envelope: COM-10, DL, C5, Monarch, Folio (216 x 330 mm) Custom size(Width: 69.8 to 216 mm, Length: 127 to 355.6 mm)
	Optional Tray A4, Letter, JIS B5, A5, Executive, Legal, Folio (216 x 330 mm)
	2Sided Printing A4, Letter, Legal
Paper Weight*3	Standard Tray 60 to 163 gsm
	Bypass Tray 60 to 230 gsm
	Optional Tray 60 to 120 gsm
	2 Sided Printing 60 to 105 gsm
Paper Tray Capacity*4	Standard Standard Tray: 250 sheets Bypass Tray: 100 sheets
	Optional 250 Sheet Feeder: 250 sheets 520 Sheet Feeder: 520 sheets
	Max 1,390 sheets [Standard Tray + Bypass Tray + 520 Sheet Feeder x 2]
Output Tray Capacity*4	150 sheets (face down), 1 sheet (face up)
CPU	Cortex-A53 1.2 GHz Dual Core
Memory Capacity	1 GB (Max: 1 GB)
Storage Device Capacity	-
Page Description Language	Standard PCL6, PostScript language compatibility
Supported Operating System*5	Standard Windows 11 (64 bit), Windows 10 (32 bit / 64 bit), Windows Server 2022 (64 bit), Windows Server 2019 (64 bit), Windows Server 2016 (64 bit) macOS 14 / 13 / 12
Interface	Standard Ethernet 1000BASE-T / 100BASE-TX / 10BASE-T
	USB Hi-Speed 2.0 Wireless LAN (IEEE802.11 b/g/n) -
Network Protocol	TCP/IP (Ipd, IPP / IPPS, Port9100)
Power Supply*6	AC220-240 V +/- 10 %, 10A, 50/60 Hz common
Operating Noise*7*8	In Operation: 7.2 B, 54 dB (A) Ready Mode: 5.3 B, 35 dB (A)
	Max 1,280 W
Maximum Power Consumption	Average Ready Mode: 31 W In Operation: 670 W
	Sleep Mode: 0.5W
Dimensions	W 373 x D 388 x H 257 mm
Weight	10.8 Kg (Including consumables and drum)
	9.5 Kg (Excluding consumables and drum)

Note: Custom Paper Size setting may be required depending on the paper size.

*1: When Continuously Printing Original in A4 (Plain). The performance may be reduced depending on the paper type and the paper size. The speed may be reduced due to the temperature conditions.

*2: When feeding from feeder tray of machine. Numeric value varies depending on output environment.

*3: It is recommended to use our recommended paper. Correct print output may not be possible depending on the requirement.

*4: 80 gsm paper.

*5: Please refer to our official website for the latest supported OS.

*6: Power outlets that provide the above power level is recommended. Maximum machine measured current: 5.3A.

*7: Measured in accordance to ISO7779. Unit B: Sound Power Level LWAd. Unit dB: Radiated Sound Pressure Level LpAm (bystander position), as reference value.

*8: Main unit only.



FUJIFILM Business Innovation Asia Pacific Pte. Ltd.

Reg. No. 199202000004 (993478-A) ST No. W10-1808-32000018

Head Office:

Ground Floor, Axis Business Park, Block C, No. 10 Jalan Bersatu 13/4, 46200 Petaling Jaya, Selangor, Malaysia.

Tel: 03-7882 2888 Fax: 03-7882 2828

Branches:

Penang: No. 3-G, 3-1 & 3-2, Persiaran Bayan Indah, Bayan Bay, 11900 Bayan Lepas Penang.

Tel: 04-643 5000 Fax: 04-644 4677

Johor Bahru: No.21 & 23, Jalan Setia Tropika 1/28, Taman Setia Tropika, 81200 Kempas, Johor Bahru.

Tel: 07-238 7868 Fax:07-238-2678

Melaka: No.17, Jalan KL3/11, Kota Laksamana, 75200 Melaka.

Tel: 06-281 0466 Fax: 06-281 0408

Kota Kinabalu: Block K, Lot 65, Ground Floor, Signature Office, Off Coastal Highway, KK Time Square, 88100 Kota Kinabalu, Sabah.

Tel: 088-486 888 Fax: 088-486 668

Kuching: No. 201, Lot 3050, Eastmoore Centre, 2 1/2 Mile Jalan Rock, 93200 Kuching, Sarawak.

Tel: 082-240 633, 082-254 633 Fax: 082-418 733

fujifilm.com/fbmy

The available model varies depending on the country/region. Please ask the sales representatives for details.

The product specifications, appearance and other details in this brochure are subject to change without notice for improvements.

Reproduction Prohibitions Please note that reproduction of the following is prohibited by law : •Domestic and foreign currencies, government-issued securities, and national bonds and local bond certificates. •Unused postage stamps, post cards, etc. •Certificate stamps stipulated by law. •Reproducing works forming the subject matter of copyright (literary works, musical works, paintings, engravings, maps, cinematographic works, drawings, photographic works, etc.) is not permitted unless the reproduction is for the purpose of personal use, family use or other similar uses within a limited circle.

Trademarks •FUJIFILM and FUJIFILM logo are registered trademarks or trademarks of FUJIFILM Corporation. •Apeos is registered trademarks or trademarks of FUJIFILM Business Innovation Corp. •Microsoft, Active Directory, Azure, Microsoft Entra, Microsoft Edge, Excel, OneDrive, PowerPoint, SharePoint, Microsoft Teams, Windows, and Windows Server are registered trademarks of US Microsoft Corporation in the U.S. and other countries. •Apple, Mac, macOS, OS X, AirPrint, and AirPrint logo are trademarks of Apple Inc. registered in the U.S. and other countries and regions. •Mopria, the Mopria Logo, and the Mopria Alliance word mark and logo are registered and/or unregistered trademarks and service marks of Mopria Alliance, Inc. in the United States and other countries. •All product names and company names mentioned in this brochure are trademarks or registered trademarks of their respective companies.

**For Your Safety**

Before using the product, read the Instruction Manual carefully for proper use. Use the product with the power source and voltage specified. Be sure to establish ground connection. Otherwise, electronic shock may result in the case of a failure or short circuit.