

COPY

1. Tap Copy on the Home Screen
2. Configure the required features
3. Set the Quantity
4. Tap Start

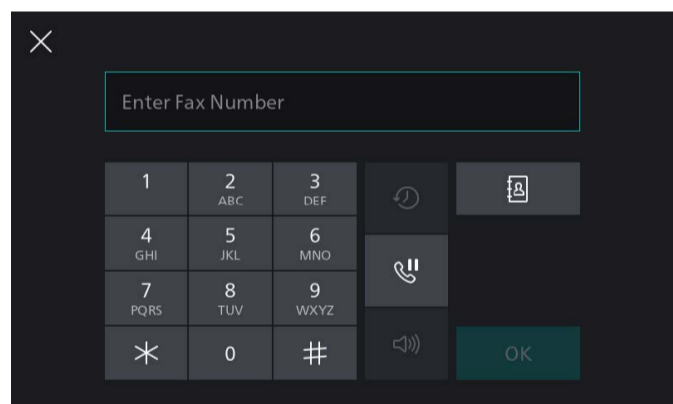

FAXING

1. Tap Fax on the Home screen
2. Enter the recipient fax number
3. Dial 0 first if required, then enter the fax number
4. Tap OK
5. Scroll the screen to change fax settings as needed
6. Tap Start

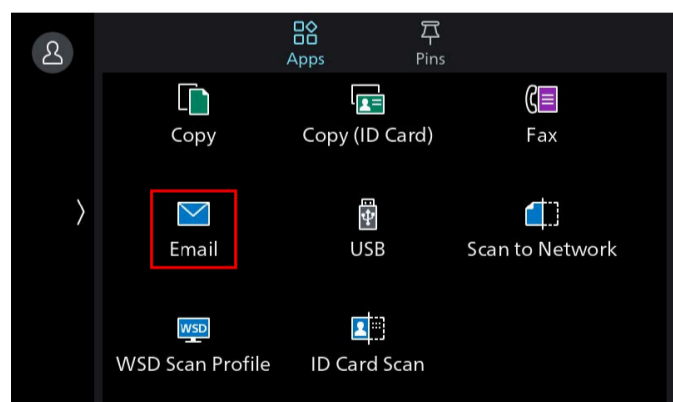

SCAN TO EMAIL

1. Tap Email on the Home Screen
2. Tap Contact
3. Tap the email address or select from the address book
4. Configure the required features
5. Tap Start



More online resources are available for your product

1. Apple iOS users: Read QR code with the mobile's camera (Note: Android use chrome web browser).
2. Other mobile users: Download a QR Code Reader Application onto your mobile device, then open the app.
3. Hold device camera over the QR.
4. The FUJIFILM Business Innovation Support Centre will open.

Access self help, drivers, documentation, videos & more:

- a. Enter your product name or number into the search box.
- b. Select your product name from the list of suggestions.
- c. Choose the type of support that you require.

support-fb.fujifilm.com